

TS Series

Illuminated Tact Switches

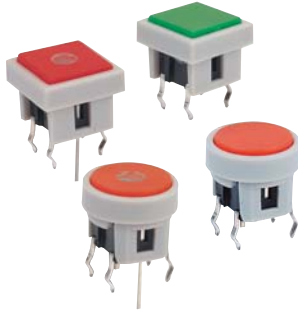

General Specifications

Circuit	:SPST
Current Rating	:50mA
Voltage Rating	:12VDC
Dielectric Withstanding Voltage	:250VAC for 1 minute
Contact Resistance	:100m Ohm Max.(initial)
Insulation Resistance	:100M Ohm Min.
Operating Force	:200gf+50gf
Total Travel	:0.25mm+0.2mm
Operating Life	:100,000 cycles Min.
Solder Specifications	:260 deg. for 3 seconds
Function	:Momentary
Operating Temperature	:-10 deg.~+60 deg.

Materials

Cap	:Acrylonitrile Butadine Styrene (ABS)
A4 type cap	:Polycarbonate (PC)
Housing	:Polyamide (PA)
Stem	:Polybutylene terephthalate (PBT)
Base	:Polyamide(PA)
Terminal	:Brass with silver plating
Action Dome	:SUS 301 with gold plating

HOW TO ORDER

TS

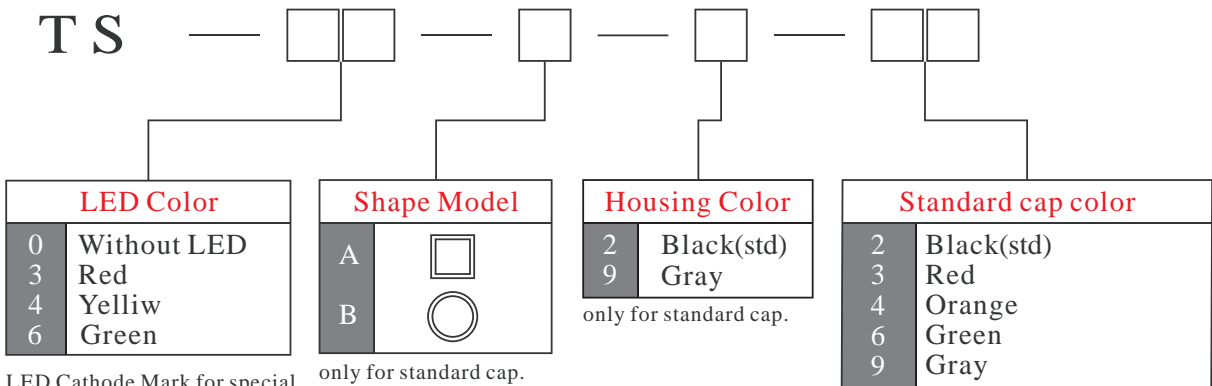

LED Cathode Mark for special order, not standard type.

only for standard cap.

EXAMPLE : TS-3-A-2-3

Illuminated tact switch-Red led-"A" Housing -Black housing - Red cap

PCB Mounting Holes & Circuit Diagram

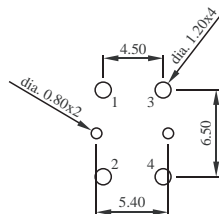

P.C.B. Mounting Holes

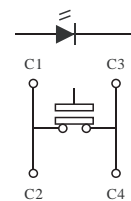

Circuit Diagram

DIMENSION

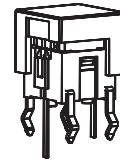
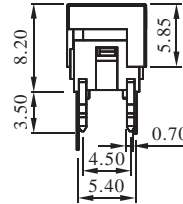
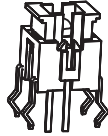
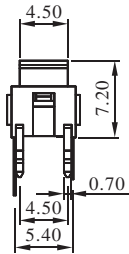
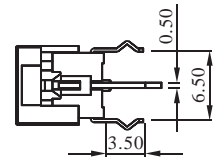
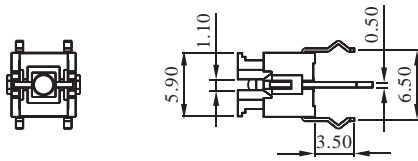

without housing and cap

without housing, "A4" type cap

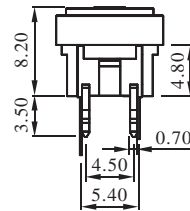
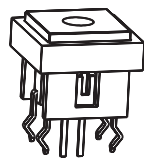
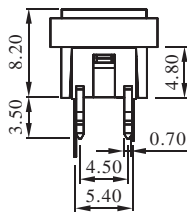
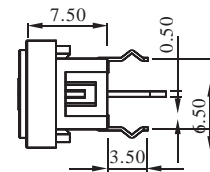
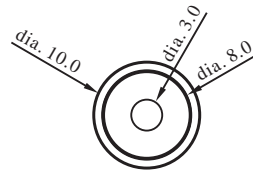
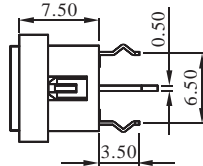
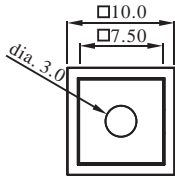

with "A" housing, LED

with "B" housing, LED

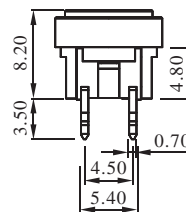
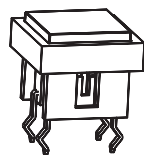
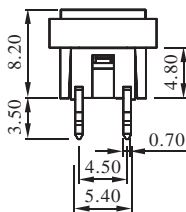
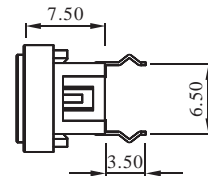
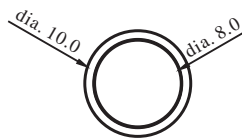
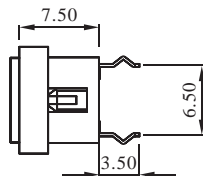
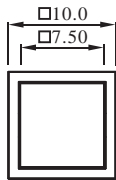

with "A" housing, not LED

with "B" housing, not LED